

CAST STEEL TILTING DISC CHECK VALVES

150 – 300 – 600 Lbs

DT-TDCV-001

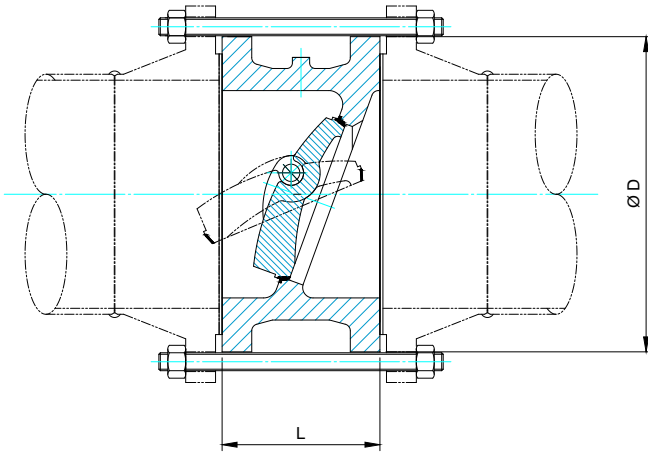

Counter flanges, piping gaskets, stud Bolts and Nuts not included

BASIC DESIGN STANDARDS

Basic Design API 594 / ANSI B16.34

Face to Face Dimension API 594

Flanges Up to 24" ANSI B16.5
From 26" MSS SP44
ANSI B16.47 API 605

Testing API 598

STANDARD DESCRIPTION

- Flow direction is stamped on body
- Wafer Type
- Suitable for mounting between flanges
- Lifting Eyebolt from 30 Kg and heavier
- Special features according to Customer's requirement
- Suitable for horizontal installation

TEST PRESSURE TO API 598 bar

| | | |
|------------|---------------|-----------|
| | Shell (water) | |
| Class 150# | Class 300# | Class 60# |
| 30 | 77 | 153 |

This document is the property of OPM ITALIA Srl. It must not be stored, reproduced or disclosed to others without written authorisation from the Company.

| | | TRIM NUMBER AS PER API 600 | | | | | | | |
|----|---------------|----------------------------|-----|----------|----------|-------|-----|----------|----------|
| No | Part Name | 1 | 2 | 8 | 5 | 9 | 10 | 12 | 16 |
| 02 | Body sealing | 410 | 304 | STL Gr.6 | STL Gr.6 | MONEL | 316 | STL Gr.6 | STL Gr.6 |
| 02 | Plate sealing | | | 410 | STL Gr.6 | | | STL Gr.6 | |
| 04 | Pin | | | 410 | 410 | | | 316 | 316 |

| BILL OF MATERIALS STANDARD ACCORDING TO ASTM | | | | | | | | | |
|--|-----------|--------------|----------|-------------|---------|-----------------|-----------|----------|-----------|
| | | Carbon Steel | | Alloy Steel | | Stainless Steel | | | |
| No | Part Name | WCB | LCB | WC6 | C5 | CF8 | CF8M | CF3 | CF3M |
| 01 | Body | A216 WCB | A352LCB | A217WC6 | A217 C5 | A351 CF8 | A351 CF8M | A351 CF3 | A351 CF3M |
| 02 | Plate | A216 WCB | A352 LCB | A217 WC6 | A217 C5 | A351 CF8 | A351 CF8M | A351 CF3 | A351 CF3M |

150 – 300 – 600 Lbs

| SIZE | | 150 Lbs | | |
|--------|-----|---------|-----|------|
| Inches | mm | L (RF) | Ø D | Kg |
| 2" | 50 | 60 | 104 | 2,5 |
| 3" | 80 | 73 | 136 | 5,5 |
| 4" | 100 | 73 | 174 | 7,0 |
| 6" | 150 | 98 | 222 | 13,5 |
| 8" | 200 | 127 | 279 | 29 |
| 10" | 250 | 146 | 340 | 47 |
| 12" | 300 | 181 | 410 | 85 |
| 14" | 350 | 184 | 451 | 96 |
| 16" | 400 | 191 | 515 | 159 |
| 18" | 450 | 203 | 550 | 180 |
| 20" | 500 | 219 | 603 | 243 |
| 24" | 600 | 222 | 717 | 394 |

| 300 Lbs | | |
|---------|-----|-----|
| L (RF) | Ø D | Kg |
| 60 | 111 | 2,7 |
| 73 | 149 | 6,3 |
| 73 | 181 | 7,0 |
| 98 | 251 | 19 |
| 127 | 308 | 35 |
| 146 | 362 | 51 |
| 181 | 423 | 88 |
| 222 | 486 | 176 |
| 232 | 539 | 185 |
| 264 | 596 | 297 |
| 292 | 654 | 365 |
| 318 | 775 | 585 |

| 600 Lbs | | |
|---------|-----|-----|
| L (RF) | Ø D | Kg |
| 60 | 111 | 2,9 |
| 73 | 149 | 6,5 |
| 79 | 194 | 8,0 |
| 136 | 267 | 33 |
| 165 | 321 | 68 |
| 213 | 430 | 104 |
| 229 | 457 | 144 |
| 273 | 492 | 196 |
| 305 | 565 | 286 |
| 362 | 613 | 401 |
| 368 | 683 | 635 |
| 438 | 790 | 918 |

CAST STEEL TILTING DISC CHECK VALVES 150# - 300# 600#