

# FORGED SWING CHECK VALVES

**800 Lbs**

**DT-FSCV-003**



**BASIC DESIGN STANDARDS**

**Basic Design** ISO 15761- BS 5352

**Wall Thickness / Pressure / Temperature** According to ANSI B16.34

**Ends** SW according to ANSI B16.11 /

**Dimensions** NPT-F according to ASME B1.20

**Bore** Reduced & Full

**TEST PRESSURE TO API 598 bar**

Class	Shell (water)	Seat (water)	Seat (air)
800	204	150	6.0

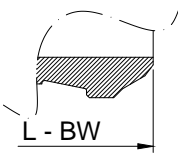

BW Welded-End version

This document is the property of OPM ITALIA Srl. It must not be stored, reproduced or disclosed to others without written authorisation from the Company.

BILL OF MATERIALS STANDARD ACCORDING TO ASTM					
No	Part Name	Carbon Steel		Alloy Steel	Stainless Steel
		A105/F6	A105/F6 HF	F11/F6 HF	SS316
01	Rivet	Carbon Steel	Carbon Steel	Carbon Steel	Carbon Steel
02	Name Plate	Aluminium	Aluminium	Aluminium	INOX
03	Cover	ASTM A105N	ASTM A105N	ASTM A182 Gr. F11	ASTM A182 Gr. F316L
04	Hinge Pin	A479 TP316	A479 TP316	A479 TP316	A479 TP316L
05	Seat	A479 TP410	A479 TP410 + ST.6	A479 TP410 + ST.6	A479 TP316L
06	Swing	A479 TP410	A479 TP410 + ST.6	A479 TP410 + ST.6	A479 TP316L
07	Hinge	ASTM A182 F316	ASTM A182 F316	ASTM A182 F316	ASTM A182 F316L
08	Nut	A194 Gr.8	A194 Gr.8	A194 Gr.8	A194 Gr.8
09	Body	ASTM A105N	ASTM A105N	ASTM A182 Gr. F11	ASTM A182 Gr. F316L

\* Recommended Spare Parts

## 800 Lbs

SIZE (Reduced Bore)		DIMENSION in mm				
Inches	mm	A	B	C	D	Kg (HANDWHEEL)
1/2"	15	-	-	-	-	-
3/4"	20	90	55	-	14	1.8
1"	25	110	70	-	18	2.6
1-1/4"	32	127	77	-	24	3.6
1-1/2"	40	130	105	-	29.5	5.5
2"	50	150	120	-	36.5	8.4

SIZE (Full Bore)		DIMENSION in mm				
Inches	mm	A	B	C	D	Kg (HANDWHEEL)
1/4"	8	-	-	-	-	-
3/8"	10	-	-	-	-	-
1/2"	15	90	55	-	14	1.8
3/4"	20	110	70	-	18	2.6
1"	25	127	77	-	24	3.6
1-1/4"	32	155	105	-	29.5	5.5
1-1/2"	40	170	120	-	36.5	8.4
2"	50	210	145	-	48	11.8

ANSI CLASS 800

PRESSURE – TEMPERATURE RATINGS TO ANSI B16.34

Temperature °C	WORKING PRESSURE (bar.g)		
	ASTM A105N (a)	ASTM A182 F11 (b)	ASTM A182 SS316 (c)
-29 to 38	136.2	137.9	132.4
93	124.1	137.9	114.1
149	120.7	132.8	103.1
204	116.5	127.6	94.5
260	110.0	122.4	87.9
316	100.7	111.4	83.1
343	98.6	108.3	81.7
371	97.9	104.5	80.0
399	92.7	97.9	78.6
427	75.8	93.4	77.6
454	49.3	89.7	76.9
482	31.7	82.8	76.2
510	19.0	58.6	71.0
538	9.6	39.7	64.5
566		26.6	63.1
593		17.6	56.2
621		11.4	43.4
649		6.9	34.1

(a) Permissible, but not recommended for prolonged usage above 427 °C  
 (b) Permissible, but not recommended for prolonged usage above 594 °C  
 (c) For welding end valves only: Flanged end ratings terminate at 538°C

FORGED STEEL SWING CHECK VALVES CLASS 800 LBS