

FORGED GATE VALVES WELDED BONNET

800 Lbs

DT-FGV-003

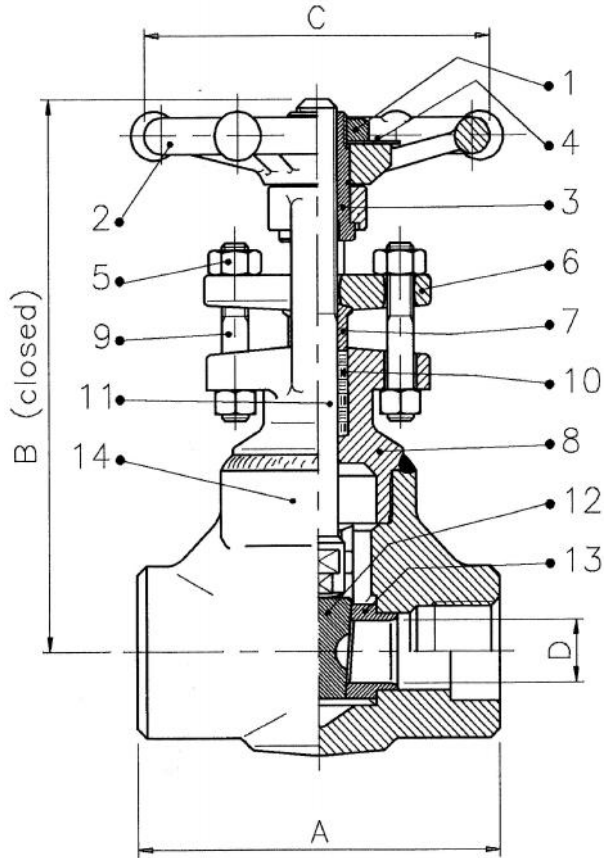

BASIC DESIGN STANDARDS

Basic Design ISO 15761 – API602

Wall Thickness / Pressure / Temperature According to ANSI B16.34

Ends SW according to ANSI B16.34 /

Dimensions NPT-F according to ASME B1.20

Bore Reduced (Full)

TEST PRESSURE TO API 598 bar

Class	Shell (water)	Seat (water)	Seat (air)
800	204	150	6.0

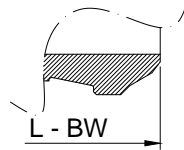

BW Welded-End version

BILL OF MATERIALS STANDARD ACCORDING TO ASTM

No	Part Name	ENI VS 215 C30 (A105/F6)	ENI VS 215 C31 (A105/304 HF)
1	Handwheel Nut	Carbon Steel	Carbon Steel
2	Handwheel	Carbon Steel	Carbon Steel
3	Yoke Sleeve	AISI 416	AISI 416
4	Name Plate	Aluminium	Aluminium
5	Gland Nuts	A194 Gr.2H	A194 Gr.2H
6	Gland Flange	ASTM A105	ASTM A105
7	Packing Gland	A479 TP316	A479 TP316
8	Bonnet	ASTM A105	ASTM A105
9	Gland Studs	AISI 410	AISI 410
10	Packing	Graphoil	Graphoil
11	Stem	A479 TP410	A479 TP410
12	Wedge	A479 TP410	A479 TP304 + STL.6
13	Seat Rings	A479 TP410	A479 TP304 + STL.6
14	Body	ASTM A105N	ASTM A105N

* Recommended Spare Parts

Other materials available on request

This document is the property of OPM ITALIA Srl. It must not be stored, reproduced or disclosed to others without written authorisation from the Company.

FORGED GATE VALVES WELDED BONNET

800 Lbs

FORGED STEEL GATE VALVES CLASS 800

ANSI CLASS 800		PRESSURE – TEMPERATURE RATINGS TO ANSI B16.34	
Temperature	WORKING PRESSURE (bar.g) ASTM A105N (a)		
°C	800#		
-29 to 38	136.2		
93	124.1		
149	120.7		
204	116.5		
260	110.0		
316	100.7		
343	98.6		
371	97.9		
399	92.7		
427	75.8		
454	49.3		
482	31.7		
510	19.0		
538	9.6		

(a) Permissible, but not recommended for prolonged usage above 427 °C
 (b) Permissible, but not recommended for prolonged usage above 594 °C
 (c) For welding end valves only: Flanged end ratings terminate at 538°C

SIZE 800# (Reduced Bore)		DIMENSION in mm				
Inches	mm	A	B	C	D	Kg (HANDWHEEL)
1/2"	15	80	145	80	10	1.6
3/4"	20	90	155	80	14	2
1"	25	110	185	100	18	3.2
1-1/4"	32	127	218	120	24	4.8
1-1/2"	40	127	255	140	30	6.5
2"	50	130	277	140	36.5	8.5

SIZE 800# (Full Bore)		DIMENSION in mm				
Inches	mm	A	B	C	D	Kg (HANDWHEEL)
1/4"	8	80	145	80	8	1.6
3/8"	10	80	145	80	10	1.6
1/2"	15	90	155	80	14	2
3/4"	20	110	185	100	18	3.2
1"	25	127	218	120	24	4.8
1-1/4"	32	127	255	140	30	6.5
1-1/2"	40	130	277	140	36.5	8.5
2"	50	150/210	327	170	48	14